

### FULLY WELDED, STAINLESS STEEL, TEMPERED GLASS FOOD SHIELDS

- Ready to Ship - Ships within 5 days from Atlanta, GA
- Freight Included (Contiguous 48 States)

#### RTS-PORTABLE-34 RTS-PORTABLE-48 RTS-PORTABLE-62

Counter Mount Optional  
by Removing "U" Base

Choose from:

- 34" - Covers Most 2 - Well Drop-In
- 48" - Covers Most 3 - Well Drop-In
- 62" - Covers Most 4 - Well Drop-In

Adequately Covers Most Chafers, Counter Top  
Induction Warmers, and Drop-Ins

*(please check dimensions on other side)*

SELF SERVE ADJUSTABLE



#### TM2N-RS-48 TM2N-RS-62

Counter Mount

Choose from:

- 48" - Covers Most 3 - Well Drop-In
- 62" - Covers Most 4 - Well Drop-In



FULL SERVE



AVAILABLE ON



Specifications for reference only and may be changed without notice. All orders require approved shop drawings prior to release to production.  
Products are drawn and built to meet NSF Standard 2. It is the responsibility of the customer to ensure product meets local health board standards.

## SELF SERVE ADJUSTABLE TECHNICAL SPECS

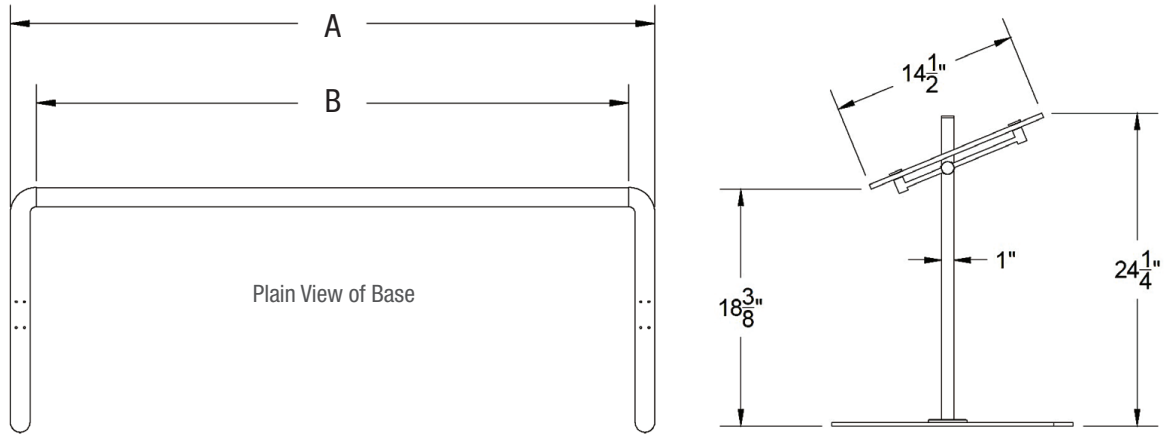

|         | RTS-Portable 34 | RTS-Portable 48 | RTS-Portable 62 |
|---------|-----------------|-----------------|-----------------|
| Outer A | 35 - 1/2"       | 49 - 1/2"       | 63 - 1/2"       |
| Inner B | 31 - 1/2"       | 45 - 1/2"       | 59 - 1/2"       |

## FULL SERVE TECHNICAL SPECS

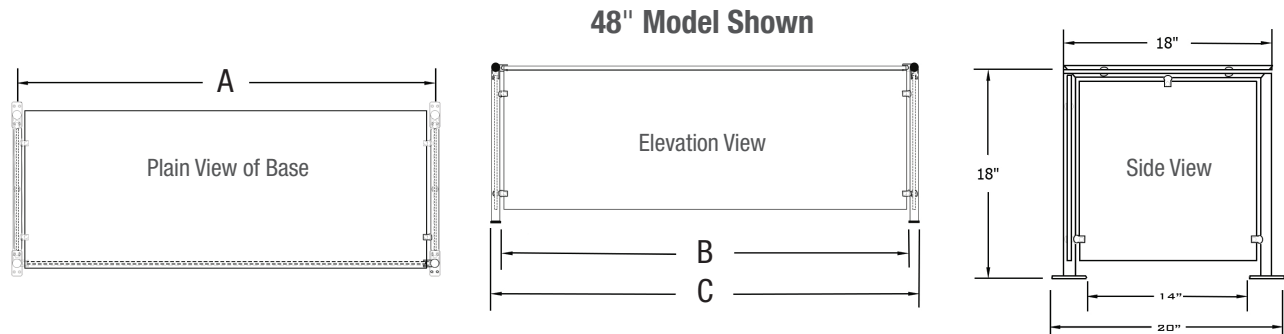

|              | TM2N-RS-48 | TM2N-RS-62 |
|--------------|------------|------------|
| Centerline A | 48"        | 62"        |
| Inner B      | 46 - 3/4"  | 60 - 3/4"  |
| Outer C      | 49 - 1/4"  | 63 - 1/4"  |

Specifications for reference only and may be changed without notice. All orders require approved shop drawings prior to release to production. Products are drawn and built to meet NSF Standard 2. It is the responsibility of the customer to ensure product meets local health board standards.